

Apalachee COURSING CLUB, INC.

Sue Christie - FTS
8 Rocky Bluff Trail
Crawfordville, FL 32327

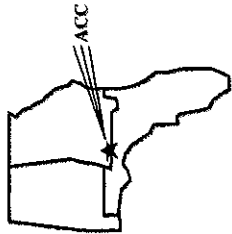

Trophies will be awarded!!!

See inside for details!

FIRST CLASS MAIL - - - PLEASE RUSH, DATED MATERIAL

DIRECTIONS:

From I-10: Take Exit #203 (Old 30), Thomasville Rd., US 319, North 4.5 miles; turn right at the traffic light on Bradfordville Rd, go 3.8 miles to Centerville Rd., turn left onto Centerville Rd, entrance will be on your right before reaching the farm managers driveway.
From Georgia via US 319: Just after crossing the state line, Highway 12 breaks off on the right; stay on 319, continue south 8.3 miles to Bradfordville Rd., on left (just past Publix shopping center); turn left, go 3.8 miles to Centerville Rd., turn left onto Centerville Rd, entrance will be on your right before reaching the farm managers driveway.
US 27 and US 90 east of Tallahassee: Can reach field by taking Chaires Crossroad, Crump Road, and Roberts Road. Turn right onto Centerville Rd, entrance on your right before reaching farm managers driveway.
From Capital Circle NE: Take Centerville Rd., 5.9 miles to Roberts/Bradfordville crossing, continue on Centerville. Entrance on your right before reaching farm managers driveway.

EARLY ENTRIES CLOSE Wednesday, February 29, 2012 at the FTS's address
Day of Trial Entries CLOSE at 7:30 AM Saturday & Sunday at the FTS's table

**PREMIUM LIST
ALL-BREED ASFA LURE FIELD TRIALS**

Apalachee COURSING CLUB, INC.



SATURDAY - March 3, 2012

SUNDAY - March 4, 2012

**SUNNY HILL FARM
TALLAHASSEE, FL**

In Region 7

EARLY ENTRY FEE: \$15.00 First Hound Per Day,
\$12.00 for Second Hound Same Household Per Day,
\$10.00 for Each Additional Hound Same Household Per Day.
DAY OF TRIAL ENTRY FEE: \$25.00 Each Hound Per day.

Permission has been granted by the American Sighthound Field Association for holding of this event under the American Sighthound Field Association Rules and Regulations.

Denise Como, Chair ASFA Scheduling Committee
Approved, 2012

APALACHEE COURSING CLUB, INC.

Officers and Directors

President - John Bruntlett **Vice President** - Sue Christie
Secretary - Alice Lubbers **Treasurer** - Elise M. Hitt
Directors - Jim Anthony, Kris Dougherty, Wayne Hitt

ACC Trophies Offered

Best in Event
Sunday

Robert Nix Memorial Trophy
 Offered by ACC

Best in Field
Saturday

Offered by Sue & Kris Christie

Afghans
Saturday
Sunday

Best of Breed
 Offered by Ruth Clevenger Reynolds
 Offered by Hope Leedom

Borzoi
Saturday/Sunday

Best of Breed
 Offered by Sue Christie

Greyhound
Saturday
Sunday

Best of Breed
 Offered by John & Laura Parker
 Offered by Glen & Pam Davis

Ibizan
Saturday
Sunday

Best of Breed
 Offered by Sue Christie
 Offered by Hope Leedom

Italian Greyhound
Saturday
Sunday

Best of Breed
 Offered by Sue Christie
 Offered by Hope Leedom

Irish Wolfhound
Saturday/Sunday

Best of Breed
 Offered by Sue Christie

Pheoah Hound
Saturday
Sunday

Best of Breed
 Offered by Sue Christie
 Offered by Hope Leedom

Rhodesian Ridgeback
Saturday/Sunday

Best of Breed
 Offered by Kris Dougherty

Salukis
Saturday
Sunday

Best of Breed
 Offered by Sue Christie
 Offered by Hope Leedom

Scottish Deerhound
Saturday
Sunday

Best of Breed
 Offered by Sue Christie
 Offered by Hope Leedom

Whippets
Saturday
Sunday

Best of Breed
 Offered by Alice Lubbers
 Offered by Hope Leedom

Whippet
Saturday/Sunday

Turtle Award
 Offered by Jenny Haverland

JUDGES, ASSIGNMENTS, & RUNNING ORDER

Christie BeetzHolister, CA
 Jim Anthony Sunrise, FL
 Jack Downing..... Lucas, TX

Saturday Running Order	A	Az	Ba	B	C	D	G	Ib	IG	IW	P	R	S	SD	SI	W	L	Sgl
Christie Beetz	L	L	L	L	L	L	L	L				L	L	L	L	L	L	L
Jim Anthony							L	L	L	L	L	L	L					
Jack Downing	L	L	L	L	L			L	L	L				L	L	L	L	L

Sunday Running Order	A	Az	Ba	B	C	D	G	Ib	IG	IW	P	R	S	SD	SI	W	L	Sgl
Christie Beetz	L	L	L	L	L	L	L	L					L	L	L	L	L	L
Jim Anthony									L	L	L	L	L	L	L	L	L	
Jack Downing	L	L	L	L	L	L	L	L	L	L	L	L						L

* = Provisional S = Single L = Licensed

FIELD COMMITTEE

Field Trial Chairman John Bruntlett (c) 850-251-7937 on field
Field Trial Secretary Sue Christie (c) 850-509-0444 on field
Lure Operators Sean McMichael, Wayne Hitt,
 Glen Davis, John Parker, Ronny Blackstock,
Huntmasters Carol Gibbons, Roxann DeVillez, Elizabeth Gearhart,
 Sean McMichael, Glen Davis, Ronny Blackstock,
Inspection Committee Roxann De Villez, Tia Lubbers, Alice Lubbers,
Elaine McMichael, Pam Mayberry, Carol Gibbons, Kris Dougherty
Equipment GuruWayne Hitt
Asst Equipment Guru.....Jim Lubbers

***** RIBBONS AND/OR AWARDS*****

BOB - Purple & Gold Rosette, **1st** - Blue, **2nd** -Red, **3rd** - Yellow, **4th** - White, **NBQ** - Green,

BIF - Red/White/Blue Rosette

ADDITIONAL INFORMATION

Kathy Archibald has once again graciously offered us the use of this beautiful field northeast of Tallahassee. Please take the time to thank her if you get the opportunity. For those of you new to joining us at this lovely site, the field is approximately 15 acres, generally flat and open yet still undulating, covered in dense grass. It is bounded on three sides by fences (two adjacent to roads) and on the fourth by a tree line, but it should not be considered absolutely dog proof. A barbed wire strand tops the heavily vegetated fences and runs through the tree line, but the courses will stay well away from this.

Running water and a portable toilet are available. No camping on site will be permitted.

NOTICE: New entry to the field! Do not enter via farm manager's driveway, see directions on front cover. Parking will be along the fenceline below the barn if soft ground is not an issue. If conditions are wet, watch for guides to firmer ground. Once the trial begins, entry and exit to the field will be controlled by the field committee. Do not open the gate to enter or leave if hounds are running without clear signal from the field committee.

We ask that everyone attending restrict themselves to the coursing field and parking areas. Plastic tape and signs will be posted to indicate closed areas (including inside the barn). Dogs may be walked along the back side of the tree line or throughout the parking areas. Please be considerate and **CLEAN UP AFTER YOUR HOUNDS and PICK UP YOUR CIGARETTE BUTTS.** Thank you, and we hope you enjoy the event and weekend.

WEEKEND WEATHER REPORT

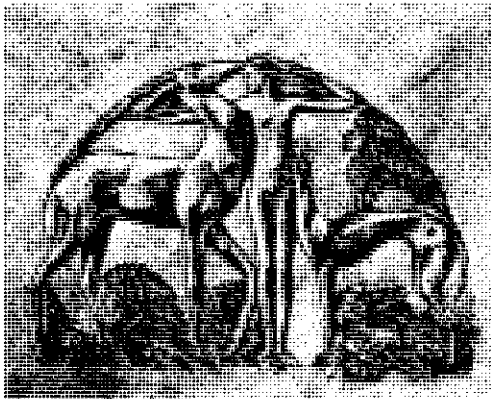

Average high 72 degrees,
average low 46 degrees.
Mean 59 degrees, Record
High 85 degrees (1955),
record low 21 degrees (2002).
Sunrise, 6:59 AM, Sunset,
6:38 PM

Trial Hours: 7:00 a.m. Saturday and Sunday until complete. Trial Roll Call 8:00 a.m. Saturday and Sunday.

Entries will NOT be acknowledged by mail.

Early Entries, with payment, must be received no later than February 29, 2012.
No phone entries, late, unsigned, incomplete or conditional entries will be accepted.

BREEDS AND ELIGIBILITY

Only purebred Afghan Hounds, Azawakhs, Basenjis, Borzois, Cirneco dell'Etna, Greyhounds, Ibizan Hounds, Irish Wolfhounds, Italian Greyhounds, Pharaoh Hounds, Salukis, Sloughis, Rhodesian Ridgebacks, Scottish Deerhounds, and Whippets may be entered in the regular stakes. Limited Breeds: Chart Polski, Galgo Espanol, Magyar Agar, Peruvian Inca Orchid, Portugese Podengo, Silken Windhound. All entries shall be individually registered with the American Kennel Club, The National Greyhound Association, the Federation Cynologique International, an ASFA-recognized foreign or ASFA board approved registry, or possess a Critique Registration Number (CRN) from the Society for the Perpetuation of the Desert-Bred Saluki (SPDBS). Limited and/or Provisional Stake entries shall be individually registered with the appropriate registry. All hounds will be checked for breed disqualifications. Late, conditional, unsigned, incomplete or unpaid entries will not be accepted.

STAKES OFFERED

OPEN: Any eligible sighthound that has met certification requirements, excluding ASFA Field Champions of record.

FIELD CHAMPION: Any ASFA Field Champion.

VETERAN: Any eligible sighthound that is at least 6 years of age or older (5 years for Irish Wolfhounds, 7 years for Afghan Hounds Rhodesian Ridgebacks & Whippets), that has met certification requirements.

SINGLES: Any eligible sighthound including those disqualified to run in other stakes - certification not required. All singles will run alone, will be scored by the judges, and will receive placements, but will not be eligible for Best of Breed. NOTE: Owners of hounds that have not previously run in practice courses are encouraged to enter their hound in the Singles stake.

LIMITED: Any eligible sighthound of a Limited or Provisional stake breed that has met certification requirements. The winner of this class is not eligible to compete in Best of Breed and/or Best in Field / Event courses.

BEST IN FIELD: Offered on Saturday. **BEST IN FIELD:** Will not be offered on Sunday.

CONDITIONS OF ENTRY

All entries must be one year of age or older on the day of the trial. Stakes will be split if entry in any one stake is 20 or more at the time of the draw. Bitches in season, hounds with breed disqualifications, and lame hounds will be excused and entry fee refunded if refund is requested. All hounds will be checked for breed disqualifications; Spayed, neutered, monorchid or cryptorchid hounds w/o breed disqualifications are eligible. Hounds with breed disqualifications are not eligible to enter except in the Single Stake. Hounds not present at the time of roll call will be scratched. Hounds will run twice in trios, if possible, or in braces unless excused, dismissed, or disqualified. A \$5.00 fine will be imposed for any loose hound on the field not competing in the course in progress. A battery-powered continuous loop lure system will be used. Spare equipment will be on hand. The lure will consist of highly visible, white plastic strips.

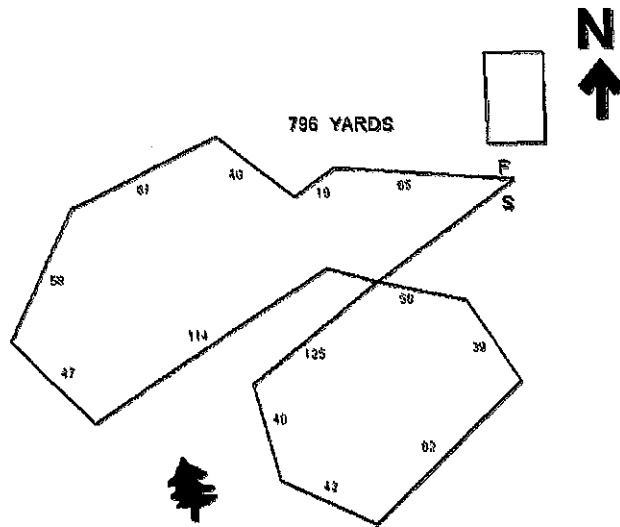

Saturday's Course Plan = 796 yards

The courses will be reversed for the finals, and again for run-offs and BOB. The club reserves the right to alter the course plans as required by weather and/or field conditions on the day of the trial.

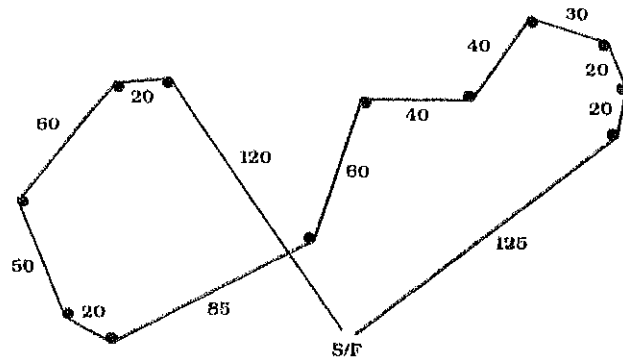

**Sunday's Course
690 yards**

Sunday's Course Plan = 690 yards

HOTELS/MOTELS THAT ALLOW PETS

**Best Western Seminole Inn (850) 656-2938
6737 Mahan Drive**

**LaQuinta (850) 385-7172
2905 N. Monroe Street (US 27 North)**

**Red Roof Inn (850) 385-7884
2930 Hospitality Street**

**Motel 6 (850) 668-2600
1481 Timberlane Road**

**Shoney's Inn (850) 386-8286
2801 N. Monroe Street (US 27 North)
\$10.00 pet deposit**

Please groom and de-flea your hounds before coming, walk them frequently outdoors, and do a little housekeeping before checkout. We hope everyone will be a good guest so we may continue to have lodging available.

CAMPING

Please Note: Camping is NOT available at the trial site.

VETERINARIAN CARE

Northwood Animal Hospital/Pets Emergency Treatment Services is providing veterinarian services as needed on call as well as a veterinarian technician on site.

Phone Number: 385-7387 Address: 1881 N. MLK Blvd.

LUNCH: SATURDAY and SUNDAY

Our Master Chef Kris Christie (and of course, Sue) will be cooking for us on site with a super spread available both days. Cost per meal is \$6.00. Any profits made from these lunch meals will go directly to the Apalachee Coursing Club, a non-profit organization.

Note: We are building an email database and will soon eliminate printing costs. Give the enclosed sign up sheet to a club officer.

Robert Nix Trophy
Offered for
BEST IN EVENT
TO BE AWARDED SUNDAY, MARCH 4, 2012

The Robert Nix Perpetual Trophy is offered annually by ACC at its spring field trials in recognition of the contributions to the sport of lure coursing by photographer Robert Nix. The Robert Nix Trophy was donated to ACC by Les Pekarski. Pictured below is last year's winner, Cookie, owned by Lisa Strickland.



To be eligible to compete for the Nix Trophy, your hound must meet these requirements:
Must compete on Saturday and Sunday; must receive a qualifying score each day in prelims and finals; must have won Best of Breed on at least Saturday or Sunday.
Best in Event is run on Sunday after all breed run-offs.

The winner of the Nix Trophy is allowed to keep the trophy until the following year's spring ACC field trials.

HOUND CERTIFICATION AND PRACTICE RUNS

ACC will hold Hound Certifications Saturday morning before competition begins and after the trial, then Practice, weather, time, and equipment permitting. You must have a hound with similar running ability available to run with the hound attempting to be certified. ACC recommends that new hounds be practiced alone as well as with other hounds before attempting a certification run. Hound Certification cost \$10.00. Practice cost \$3.00.

Email Premium List Sign-up

In an effort to cut cost of postage, ACC will soon stop using the US Mail / printed premium lists.

Please provide your information below and include this page with your entry for this trial or give to a club officer during the trial. You may also email the information to ACC at yilviin2@earthlink.net at any time to change your email address.

Your Name: _____

Your email address is: _____

Trial Photographer: UmaRapiti Photography

*Southeastern Greyhound Adoption GPA - Tallahassee will hold a 50/50 raffle both days. Tickets \$1.00 each or 6 for \$5.00
Please support greyhound rescue & adoption!*

Visit our website at www.lurecoursing.org

OFFICIAL AMERICAN SIGHTHOUND FIELD ASSOCIATION ENTRY FORM

Apalachee Coursing Club, Inc.

All Breed Lure Trial

Sunday, March 4, 2012

EARLY ENTRY FEE: \$15.00 Each Hound; \$12.00 Second Hound Same House; \$10.00 Each Additional Hound Same House. Early entries close, February 29, 2012 at FTS address.

Hound Certification or Waiver required for all first time competitors except Singles.

DAY OF TRIAL ENTRY FEE: \$25.00 Each Hound. Day of trial entries close at 7:30 A.M. at FTS table.

Make checks payable to ACC and mail entries w/check to:

Sue Christie, FTS, 8 Rocky Bluff Trail, Crawfordville, FL 32327 (850) 509-0444

Fee Paid _____ The Field Secretary cannot accept conditional, unsigned, incomplete or unpaid entries; please check your completed entry carefully.

Breed:		Call Name:	
Registered Name of Hound:			
Stake: <input type="checkbox"/> Open <input type="checkbox"/> FCH <input type="checkbox"/> Veteran <input type="checkbox"/> Single <input type="checkbox"/> Limited		Additional Stakes: <input type="checkbox"/> Kennel <input type="checkbox"/> Breeder <input type="checkbox"/> Bench	
Registration Number: (circle one) AKC Reg. # AKC ILP/PAL: NGA #: Critique Reg #: Foreign Reg. # & Country: Pending: UKC Reg. #			
<input type="checkbox"/> If possible, please separate my hounds	Date of Birth:	Sex: <input type="checkbox"/> Dog <input type="checkbox"/> Bitch	
Name of actual owner(s):			
Address:		Phone:	
City:		State:	Zip:
E-mail (Optional)		(Optional) Region of Residence:	
<input type="checkbox"/> Check if this is the first ASFA trial for this hound. Attach a Hound Certification or waiver if entered in Open, Veterans, Limited.			
<input type="checkbox"/> Check if this is a first-time entry, a copy of the official Registration of this hound must accompany this entry unless NGA.			
<input type="checkbox"/> Check if any information has changed since the last ASFA trial entry. Regarding _____			
<input type="checkbox"/> Check if this hound has been dismissed within the last 6 trials entered. Must be marked in order to qualify for a "clean" trial requirement.			

I CERTIFY that I am the actual owner of this dog, or that I am the duly authorized agent of the actual owner whose name I have entered above. In consideration of the acceptance of this entry and the opportunity to have this dog judged and to win prize money, ribbons, or trophies, I (we) agree to abide by the rules and regulations of the American Sighthound Field Association in effect at the time of this lure field trial, and by any additional rules and regulations appearing in the premium list for this lure field trial. I (we) agree that the club holding this lure field trial has the right to refuse this entry for cause, which the club shall deem to be sufficient. I (we) agree to hold this club, its members, directors, governors, officers, agents or other functionaries, any employees of the aforementioned parties and the owner(s) of the trial premises or grounds harmless from any claim for loss or injury which may be alleged to have been caused directly or indirectly to any person or thing by the act of this dog while in or upon the lure field trial premises or grounds or near any entrance thereto and I (we) personally assume all responsibility and liability for any such claim, and I (we) further agree to hold the aforementioned parties harmless from any claim loss of this dog by disappearance, theft damage or injury be caused or alleged to be caused by the negligence of the club or any of the aforementioned parties or by the negligence of any person or any other cause or causes. I (we) certify and represent that the dog entered is not a hazard to person or other dogs. This entry is submitted for acceptance of the foregoing representations and agreements

SIGNATURE of owner or his agent
duly authorized to make this entry _____

OFFICIAL AMERICAN SIGHTHOUND FIELD ASSOCIATION ENTRY FORM

Apalachee Coursing Club, Inc.

All Breed Lure Trial

Saturday, March 3, 2012

EARLY ENTRY FEE: \$15.00 Each Hound; \$12.00 Second Hound Same House; \$10.00 Each Additional Hound Same House. Early entries close, February 29, 2012 at FTS address.

Hound Certification or Waiver required for all first time competitors except Singles.

DAY OF TRIAL ENTRY FEE: \$25.00 Each Hound. Day of trial entries close at 7:30 A.M. at FTS table.

Make checks payable to ACC and mail entries w/check to:

Sue Christie, FTS, 8 Rocky Bluff Trail, Crawfordville, FL 32327 (850) 509-0444

Fee Paid _____ The Field Secretary cannot accept conditional, unsigned, incomplete or unpaid entries; please check your completed entry carefully.

Breed:		Call Name:	
Registered Name of Hound:			
Stake: <input type="checkbox"/> Open <input type="checkbox"/> FCH <input type="checkbox"/> Veteran <input type="checkbox"/> Single <input type="checkbox"/> Limited		Additional Stakes: <input type="checkbox"/> Kennel <input type="checkbox"/> Breeder <input type="checkbox"/> Bench	
Registration Number: (circle one) AKC Reg. # AKC ILP/PAL: NGA #: Critique Reg #: Foreign Reg. # & Country: Pending: UKC Reg. #			
<input type="checkbox"/> If possible, please separate my hounds	Date of Birth:	Sex: <input type="checkbox"/> Dog <input type="checkbox"/> Bitch	
Name of actual owner(s):			
Address:		Phone:	
City:		State:	Zip:
E-mail (Optional)		(Optional) Region of Residence:	
<input type="checkbox"/> Check if this is the first ASFA trial for this hound. Attach a Hound Certification or waiver if entered in Open, Veterans, Limited.			
<input type="checkbox"/> Check if this is a first-time entry, a copy of the official Registration of this hound must accompany this entry unless NGA.			
<input type="checkbox"/> Check if any information has changed since the last ASFA trial entry. Regarding _____			
<input type="checkbox"/> Check if this hound has been dismissed within the last 6 trials entered. Must be marked in order to qualify for a "clean" trial requirement.			

I CERTIFY that I am the actual owner of this dog, or that I am the duly authorized agent of the actual owner whose name I have entered above. In consideration of the acceptance of this entry and the opportunity to have this dog judged and to win prize money, ribbons, or trophies, I (we) agree to abide by the rules and regulations of the American Sighthound Field Association in effect at the time of this lure field trial, and by any additional rules and regulations appearing in the premium list for this lure field trial. I (we) agree that the club holding this lure field trial has the right to refuse this entry for cause, which the club shall deem to be sufficient. I (we) agree to hold this club, its members, directors, governors, officers, agents or other functionaries, any employees of the aforementioned parties and the owner(s) of the trial premises or grounds harmless from any claim for loss or injury which may be alleged to have been caused directly or indirectly to any person or thing by the act of this dog while in or upon the lure field trial premises or grounds or near any entrance thereto and I (we) personally assume all responsibility and liability for any such claim, and I (we) further agree to hold the aforementioned parties harmless from any claim loss of this dog by disappearance, theft damage or injury be caused or alleged to be caused by the negligence of the club or any of the aforementioned parties or by the negligence of any person or any other cause or causes. I (we) certify and represent that the dog entered is not a hazard to person or other dogs. This entry is submitted for acceptance of the foregoing representations and agreements

SIGNATURE of owner or his agent
duly authorized to make this entry _____

**AMERICAN SIGHTHOUND FIELD ASSOCIATION
HOUND CERTIFICATION**

Rule effective October 1, 1994: Ch. V, Sec. 4 (a) OPEN STAKE: *To be eligible to enter the open stake, a hound must have been certified by a licensed judge within the year preceding the closing date for the entry or have previously competed in the Open Stake. This eligibility requirement also applies to a hound entered in the Limited or Veteran Stake, which has not competed in Open previously. Please complete this portion of this form and attach it to the entry form for the hound's first entry, including an entry for a Fun Trial.*

Registered Name of Hound: _____

Registration Number: _____ Breed: _____

Registered Owner's Name: _____

I hereby certify that on (date) _____, the above named hound completed a lure course of at least 500 yards, running with another hound of the same breed (or another breed with a similar running style). During the course the above named hound showed no inclination to interfere with the other hound. I further certify that I am a licensed judge for the ASFA.

Name of Licensed Judge: _____

Signature: _____ Date: _____

I hereby certify that the hound running in the certification course is the hound identified above and that information provided on this form is true and correct.

Signature: _____ Date: _____

Owner or Authorized Agent of Hound

This certification form must be attached to the entry form the first time this hound is entered in an open, limited, or veteran stake. Any hound entered in open, limited, or veteran (as a first time entered hound), which has not been certified, shall be declared ineligible by the records coordinator and shall forfeit any points and placements awarded.

PLEASE RETAIN A COPY FOR YOUR RECORDS.

**AMERICAN SIGHTHOUND FIELD ASSOCIATION
HOUND CERTIFICATION WAIVER**

Waiver of Requirement: *This requirement will be waived for a hound that has earned a lure coursing or racing title from another recognized organization, if such title requires competition, and if a waiver for such title has been approved by the ASFA, or a CKC Hound Certification Form. If your hound qualifies for a waiver, complete this portion of this form and attach it to your entry form. Proof of waivers must accompany this certification form.*

Registered Name of Hound: _____

Registration Number: _____ Breed: _____

Registered Owner's Name: _____

CKC: FCH FCHX **CWA:** ARX TRP SRA DPC

AKC: FC SC **QC LGRA:** GRC **NAWRA:** RCH SR

WRA: CR WRCH **NOTRA:** ORC OTR SORC SOR

Hound Certification previously submitted.

I hereby certify that the hound identified above has completed the requirements for the title indicated above (or that the required Certification was previously submitted) and that the information provided on this form is true and correct.

Signature: _____ Date: _____

Owner or Authorized Agent of Hound

**AMERICAN SIGHTHOUND FIELD ASSOCIATION
HOUND CERTIFICATION**

Rule effective October 1, 1994: Ch. V, Sec. 4 (a) OPEN STAKE: *To be eligible to enter the open stake, a hound must have been certified by a licensed judge within the year preceding the closing date for the entry or have previously competed in the Open Stake. This eligibility requirement also applies to a hound entered in the Limited or Veteran Stake, which has not competed in Open previously. Please complete this portion of this form and attach it to the entry form for the hound's first entry, including an entry for a Fun Trial.*

Registered Name of Hound: _____

Registration Number: _____ Breed: _____

Registered Owner's Name: _____

I hereby certify that on (date) _____, the above named hound completed a lure course of at least 500 yards, running with another hound of the same breed (or another breed with a similar running style). During the course the above named hound showed no inclination to interfere with the other hound. I further certify that I am a licensed judge for the ASFA.

Name of Licensed Judge: _____

Signature: _____ Date: _____

I hereby certify that the hound running in the certification course is the hound identified above and that information provided on this form is true and correct.

Signature: _____ Date: _____

Owner or Authorized Agent of Hound

This certification form must be attached to the entry form the first time this hound is entered in an open, limited, or veteran stake. Any hound entered in open, limited, or veteran (as a first time entered hound), which has not been certified, shall be declared ineligible by the records coordinator and shall forfeit any points and placements awarded.

PLEASE RETAIN A COPY FOR YOUR RECORDS.

**AMERICAN SIGHTHOUND FIELD ASSOCIATION
HOUND CERTIFICATION WAIVER**

Waiver of Requirement: *This requirement will be waived for a hound that has earned a lure coursing or racing title from another recognized organization, if such title requires competition, and if a waiver for such title has been approved by the ASFA, or a CKC Hound Certification Form. If your hound qualifies for a waiver, complete this portion of this form and attach it to your entry form. Proof of waivers must accompany this certification form.*

Registered Name of Hound: _____

Registration Number: _____ Breed: _____

Registered Owner's Name: _____

CKC: FCH FCHX **CWA:** ARX TRP SRA DPC

AKC: FC SC **QC LGRA:** GRC **NAWRA:** RCH SR

WRA: CR WRCH **NOTRA:** ORC OTR SORC SOR

Hound Certification previously submitted.

I hereby certify that the hound identified above has completed the requirements for the title indicated above (or that the required Certification was previously submitted) and that the information provided on this form is true and correct.

Signature: _____ Date: _____

Owner or Authorized Agent of Hound